

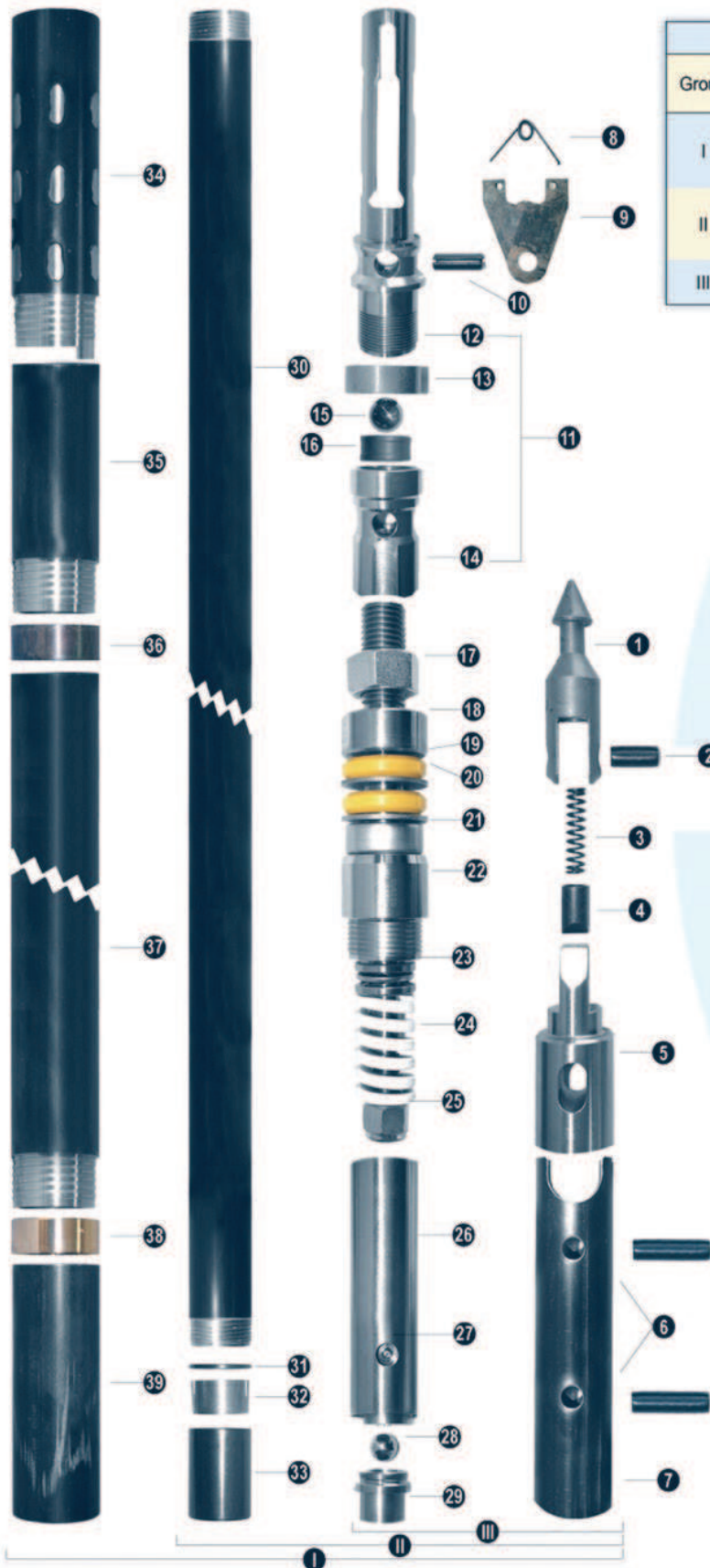

# WIRELINE CORE BARREL

## "Knuckle Head" Size : N



ASSEMBLIES				
Group	Description	Part No	Weight	
			lb	kg
I	Core Barrel Assy FF			
	5'	WN0205	89.70	40.7
	10'	WN0210	138.00	62.4
II	Inner Tube Assy FF			
	5'	WN1205	34.40	15.6
	10'	WN1210	47.00	21.3
III	Head Assy FF	WN2002	20.13	9.1

1	Spearhead point	WBNH2201
2	Spiral pin (7/16" X 1")	WBNH2205
3	Compression spring	WBNH2202
4	Detent plunger	WBNH2203
5	Spearhead base	WN2204
6	Spring pin (2) (1/2" x 2")	WN2103
7	Latch retracting case	WN2206
8	Latch spring	WN2104
9	Latch (2)	WN2105
10	Spiral pin (1/4" x 1 1/2")	WN2108
11	Latch body assy	WN2909
12	Upper body	WN2909-1
13	Landing shoulder	WN2909-2
14	Lower body	WN2909-3
15	Steel ball 22 mm	WBNH2909-4
16	Landing indicator bushing	WBNH2909-5
17	Lock nut	WN2110
18	Spindel assy	WN2111
19	Shut-off valve (2)	WN2112U
20	Valve adjusting washer (2)	WN2113
21	Ball thrust bearing	WN2114
22	Spindle bearing	WN2115
23	Hanger bearing	WN2124
24	Compression spring	WN2116
25	Self lock nut	WN2117
26	Inner tube cap assy FF	WN2119
27	Grease fitting	WB2120
28	Steel ball (7/8")	WN2121
29	Check valve body	WN2123
30	Inner tube 5'	ITN2125
30	Inner tube 10'	ITN2130
31	Stop ring	WN2132
32	Core lifter	WN2133
33	Core lifter case	WN2131
34	Locking coupling standard	WN2134
35	Adaptor coupling	WN2135
36	Landing ring	WN2136
37	Outer tube 5'	OTN2145
37	Outer tube 10'	OTN2150
38	Inner tube stabilizer	WN2139
39	Thread protector	WN2140